

PIERCE SCHOOL WEEKLY UPDATE, 06/27/25



SCHOOL STREET WILL BE CLOSED FROM 7:00AM-4:30PM DAILY THROUGH LABOR DAY

THIS WEEK (June 23-27)

- Excavate for interior footings.
- Form/Rebar/Pour footings, walls and piers
- Trench for new utilities in Harvard Street
- Install piles along parking lot side of Hist. Bldg.
- Test pit and excavation/demo behind Hist. Bldg
- Install steel for mock-up
- Deliver and fabricate geothermal pipe mains.

PROJECT TRACKING:

- Footings: 27%; wall: 16%; piers: 15%

ANTICIPATING NEXT WEEK (June 30-July 4)

- In-road utility work continues in School Street
- F/R/P footings, high and low walls, piers
- Trench for and install geothermal mains
- Install piles/lagging at Historic Building
- Pour level 2 deck at mock-up

MILESTONES:

- Complete concrete walls 'A' side: 07/11/25

Narrative:

Our schedule of pouring concrete on Tuesdays and Thursdays continued this week (see next page for graphic) despite the brutal heat early in the week. The site contractor continued with excavation, fill and compaction for the next areas of foundation work and added a second crew for site work at the back of the Historic Building. They also added a second utility crew for installing new utility connections on School Street. There were no reported issues with the closure of School Street in the first week, and police details assisted in ensuring that business owners and residents had access.

At the Historic Building, steel H piles were installed for the upcoming Support of Excavation (SOE) adjacent to the parking lot. Electricians were on site to work on temporary power, and a geothermal pipe crew mobilized and began assembling the 10" main pipes that will connect to the well field that will be below Pierce Park.

The steel structure for the mockup was delivered and installed.



Overall, the project remains on schedule.

For other project details, please visit the Project Website: <https://www.brookline.k12.ma.us/Page/2463>

To sign up for Project Updates, please go to: <https://www.brooklinema.gov/list.aspx?ListID=816>

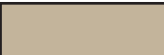

Bldg A | Bldg B

-  Footing/Site Prep
-  Footings
-  Foundation Walls

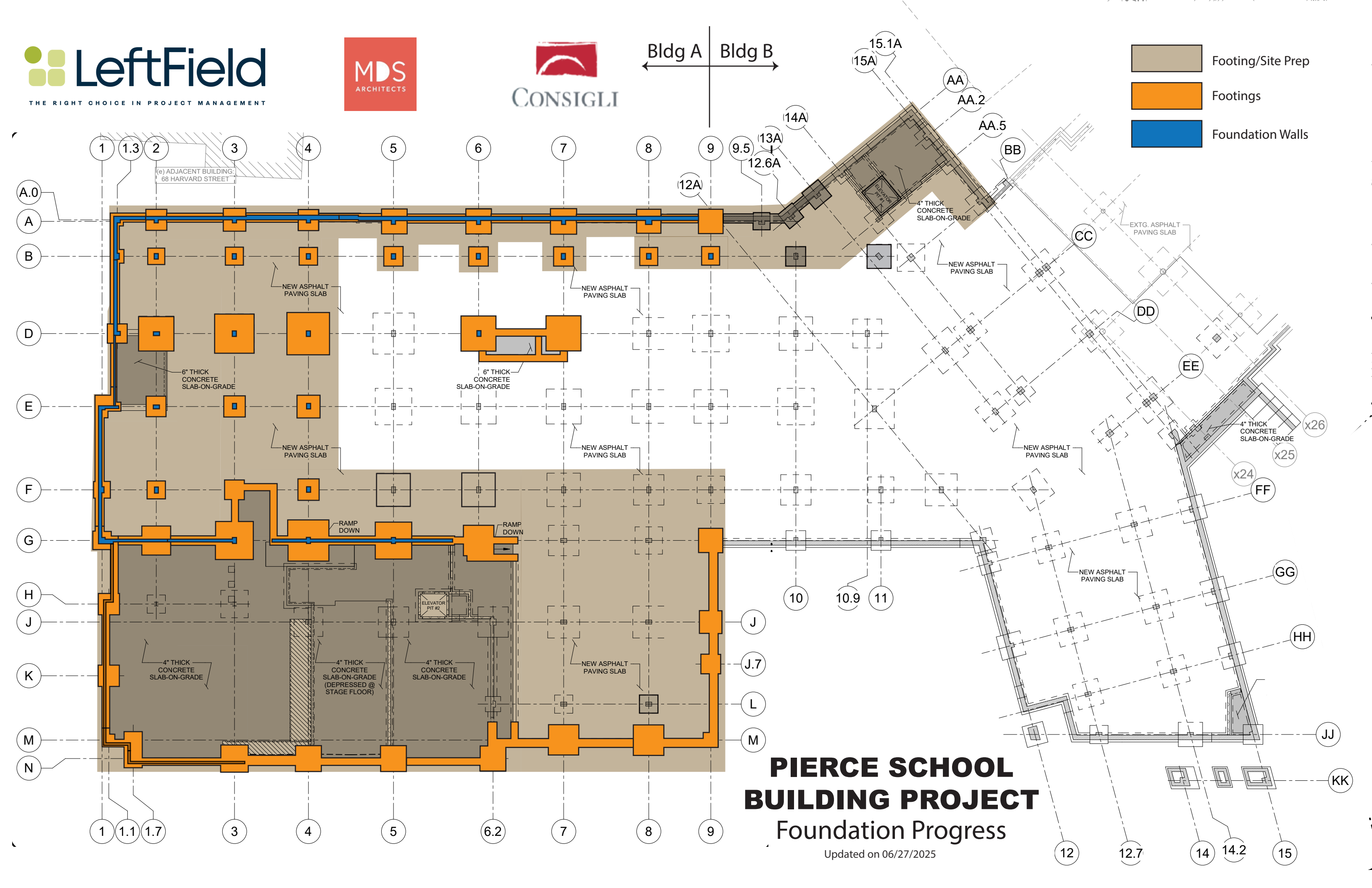

**PIERCE SCHOOL
BUILDING PROJECT**
Foundation Progress

Updated on 06/27/2025